

HIGH VOLTAGE COPPER TERMINALS CA RANGE for copper conductors



Description:

- Serie CA-M terminals is designed for high voltage applications up to 33 kV.
- CA-M serie lugs is manufactured from electrolytic copper tube Cu-OF CW008A conform to UNI EN 13600:2003. The dimensions of the tube are designed to obtain the most efficient electrical conductivity and mechanical strength to resist vibration and pull out.
- The extended barrel enhances both electrical and mechanical performance.
- The absence of an inspection hole prevents moisture entry into the crimped joint and makes these terminals suitable for outdoor applications.
- Lugs are electrolytically tin plated, with a minimum thickness of 3µm, to avoid oxidation.

Sections and Dimensions:

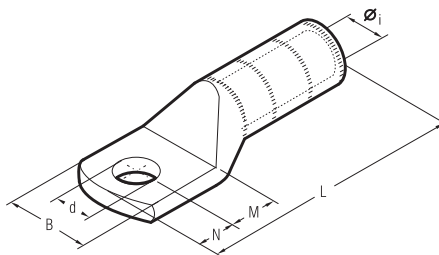

Conductor Size sqmm	Ø Stud mm	Ref.	Dimensions mm					
			Øi	B	M	N	L	d
25 R	8	CA 25-M 8	6,8	14,0	9	8	65,0	8,4
	10	CA 25-M 10	6,8	18,0	13	11	72,0	10,5
	12	CA 25-M 12	6,8	21,0	16	14	78,0	13,2
30 RC/S ÷ 40 S	12	CA 40 S-M 12	8,2	21,0	16	14	79,0	13,2
	16	CA 40 S-M 16	8,2	26,0	19	17	85,0	17,0
50 RC	12	CA 50 R-M 12	8,7	20,5	16	14	79,0	13,2
50 S	12	CA 50 S-M 12	9,5	21,0	16	14	79,0	13,2
	16	CA 50 S-M 16	9,5	26,0	19	17	85,0	17,0
63 S ÷ 70 S	12	CA 70 S-M 12	11,0	28,0	16	14	81,2	13,2
	16	CA 70 S-M 16	11,0	30,0	19	17	87,2	17,0
80 S ÷ 95 RC	12	CA 95 R-M 12	12,0	28,0	16	14	91,0	13,2
	14	CA 95 R-M 14	12,0	29,0	18	16	95,0	15,0
95 S ÷ 100 S	12	CA 95 S-M 12	13,5	28,0	16	14	91,0	13,2
	14	CA 95 S-M 14	13,5	29,0	18	16	94,5	15,0
	16	CA 95 S-M 16	13,5	30,0	20	17	97,0	17,0
120 RC/S ÷ 150 RC	12	CA 150 R-M 12	15,0	31,0	16	14	97,0	13,2
	14	CA 150 R-M 14	15,0	31,0	18	16	101,0	15,0
150 S ÷ 160 RC	12	CA 150 S-M 12	16,5	32,0	16	14	97,0	13,2
	14	CA 150 S-M 14	16,5	32,0	18	16	101,0	15,0
160 S ÷ 200 RC	14	CA 200 R-M 14	17,0	32,5	18	16	101,0	15,0
200 S ÷ 240 RC	14	CA 240 R-M 14	19,2	43,0	18	16	107,0	15,0
240 S ÷ 315 RC	14	CA 315 R-M 14	21,5	43,0	18	16	105,0	15,0
	315 S	CA 315 S-M 14	23,7	44,0	18	16	105,0	15,0

R = Round conductors RC = Round Compact conductors S = Sector shaped conductors

Cembre SpA

Via Serenissima, 9 - 25135 Brescia (Italy)

Tel.: +39 030 36921 - Telefax: +39 030 3365766

www.cembre.com - E-mail: info@cembre.com