

COPPER TUBE LUGS 4-ESI FIXING A-4ESI

A-4ESI series lugs are made from high purity electrolytic copper tube, annealed and tin plated. The four hole stud fixing in accordance with E.A. specifications ensures compatibility with most transformer fixing arrangements.



COPPER TUBE LUGS 4-ESI FIXING A-4ESI

Technical characteristics

Material (Body)

ETP Copper electrolytically tinned

Material (Fixing)

ETP Copper electrolytically tinned

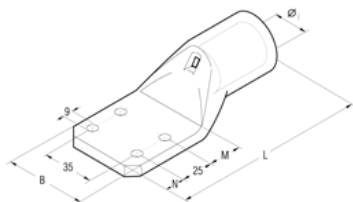

COPPER TUBE LUGS 4-ESI FIXING A-4ESI

List of products

A-4ESI *Cable type: copper, Maximum section: 185 mm²*



Type	B	L	Number the hole	Pack qty	Min. pack qty	M	N	Center distances	Øi
A37-4ESI	61 mm	124 mm	4	20	10	20 mm	15 mm	25L-35B	19.2 mm

A-4ESI *Cable type: flexible copper, Maximum section: 185 mm²*



Type	B	L	Number the hole	Pack qty	Min. pack qty	M	N	Center distances	Øi
A37-4ESI	61 mm	124 mm	4	20	10	20 mm	15 mm	25L-35B	19.2 mm

A-4ESI *Cable type: copper, Maximum section: 240 mm²*



Type	B	L	Number the hole	Pack qty	Min. pack qty	M	N	Center distances	Øi
A48-4ESI	61 mm	128 mm	4	20	10	20 mm	15 mm	25L-35B	21.1 mm

A-4ESI *Cable type: flexible copper, Maximum section: 240 mm²*

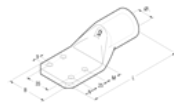

Type	B	L	Number the hole	Pack qty	Min. pack qty	M	N	Center distances	Øi
A48-4ESI	61 mm	128 mm	4	20	10	20 mm	15 mm	25L-35B	21.1 mm

A-4ESI Cable type: flexible copper, Maximum section: 300 mm²

Type	B	L	Number the hole	Pack qty	Min. pack qty	M	N	Center distances	Øi
A60-4ESI	61 mm	133 mm	4	15	5	20 mm	15 mm	25L-35B	23.7 mm

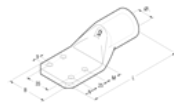
A-4ESI Cable type: copper, Maximum section: 300 mm²

Type	B	L	Number the hole	Pack qty	Min. pack qty	M	N	Center distances	Øi
A60-4ESI	61 mm	133 mm	4	15	5	20 mm	15 mm	25L-35B	23.7 mm

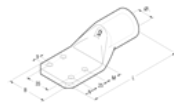
A-4ESI Cable type: flexible copper, Maximum section: 400 mm²

Type	B	L	Number the hole	Pack qty	Min. pack qty	M	N	Center distances	Øi
A80-4ESI	61 mm	134 mm	4	15	5	20 mm	15 mm	25L-35B	27 mm

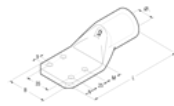
A-4ESI Cable type: copper, Maximum section: 400 mm²

Type	B	L	Number the hole	Pack qty	Min. pack qty	M	N	Center distances	Øi
A80-4ESI	61 mm	134 mm	4	15	5	20 mm	15 mm	25L-35B	27 mm

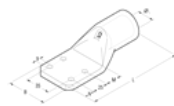
A-4ESI Cable type: flexible copper, Maximum section: 500 mm²

Type	B	L	Number the hole	Pack qty	Min. pack qty	M	N	Center distances	Øi
A100-4ESI	61 mm	139 mm	4	10	5	20 mm	15 mm	25L-35B	30.3 mm

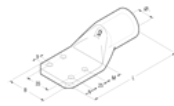
A-4ESI Cable type: copper, Maximum section: 500 mm²

Type	B	L	Number the hole	Pack qty	Min. pack qty	M	N	Center distances	Øi
A100-4ESI	61 mm	139 mm	4	10	5	20 mm	15 mm	25L-35B	30.3 mm

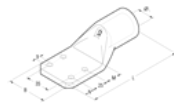
A-4ESI Cable type: flexible copper, Maximum section: 630 mm²

Type	B	L	Number the hole	Pack qty	Min. pack qty	M	N	Center distances	Øi
A120-4ESI	61.6 mm	144 mm	4	10	5	20 mm	15 mm	25L-35B	33.4 mm

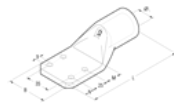
A-4ESI Cable type: copper, Maximum section: 630 mm²

Type	B	L	Number the hole	Pack qty	Min. pack qty	M	N	Center distances	Øi
A120-4ESI	61.6 mm	144 mm	4	10	5	20 mm	15 mm	25L-35B	33.4 mm

A-4ESI Cable type: flexible copper, Maximum section: 800 mm²

Type	B	L	Number the hole	Pack qty	Min. pack qty	M	N	Center distances	Øi
A160-4ESI	61 mm	158 mm	4	8	1	20 mm	15 mm	25L-35B	38 mm

A-4ESI Cable type: copper, Maximum section: 800 mm²

Type	B	L	Number the hole	Pack qty	Min. pack qty	M	N	Center distances	Øi
A160-4ESI	61 mm	158 mm	4	8	1	20 mm	15 mm	25L-35B	38 mm