

C25-100-METAL AND C3/4-100-METAL

COLD APPLIED METAL CONNECTION KIT

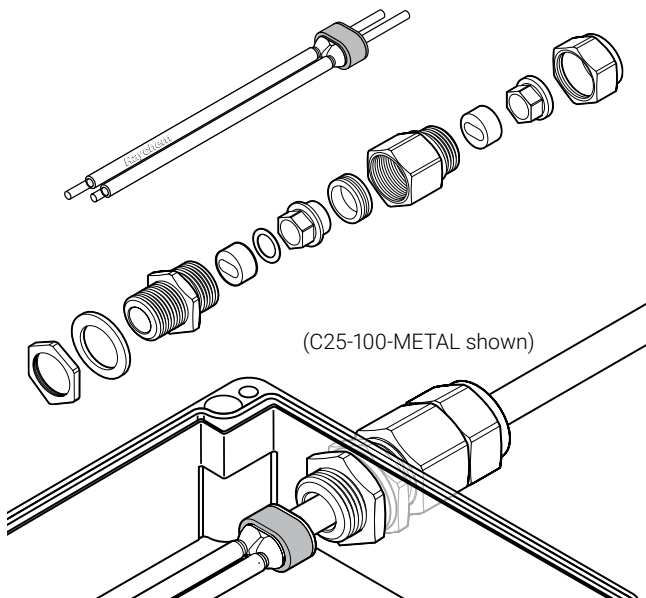

These connection kits are designed for terminating all nVent RAYCHEM BTV, QTVR, XTV, KTV and VPL industrial parallel heating cables to a junction box, whilst maintaining electrical insulation of the heating cable conductors and core.

The braid is directly connected to the metal gland body. The connection kits can be used with metal boxes or plastic boxes with internal earthing plate. They are approved for use in hazardous areas.

The core sealing boot does not require a heat gun or torch for the installation (no hot work permit necessary). The non-curing sealant (silicone free) allows easy installation and facilitates maintenance purposes.

The C25-100-METAL kit is designed for use with M25 entries, the C3/4-100-METAL for 3/4" NPT entries.

A metal locknut is provided for earth bonding in plastic junction boxes.

APPLICATION

nVent RAYCHEM C25-100-METAL

C3/4-100-METAL



Connection kit for BTV, QTVR, XTV, KTV and VPL parallel heating cables

KIT CONTENTS

- 1 gland,
- 2 grommets,
- 1 locknut and sealing washer (only M25),
- 1 core sealer,
- 1 installation instruction (multilingual).



APPROVALS



FOR METAL GLAND

Sira 01ATEX1270X
 II 2GD Ex d IIC Ex tD A21 IP68
 II 2GD Ex e IIC Ex tD A21 IP68
 IECEx SIR 05.0020X
 Ex d IIC Ex e II Ex tD A21 IP6X

FOR C25-100METAL AND C3/4-100-METAL

Baseefa16ATEX0039U
 II 2 GD Ex eb IIC Gb
 Ex tb IIIC Db
 IECEx BAS 16.0042U
 Ex eb IIC Gb Ex tb IIIC Db

  TC RU C-BE.MIO62.B.00054/18
 Ex e IIC Gb U Ex tb IIIC Db U
 Ta -60°C...+180°C IP68
 OOO "TexИмпорт"

  TC RU C-BE.MIO62.B.00054/18
 Ex e IIC Gb U Ex tb IIIC Db U
 Ta -60°C...+180°C IP68
 OOO "TexИмпорт"

SPECIFICATION FOR GLAND

	C25-100-METAL	C3/4-100-METAL
Area classification	Hazardous Zone 1 and 2 (Gas), Zone 21 and 22 (Dust), ordinary In- and outdoors	Hazardous Zone 1 and 2 (Gas), Zone 21 and 22 (Dust), ordinary In- and outdoors
Thread size	M25 x 1.5	3/4" NPT
Gland material	Brass	Brass
Min. ambient temperature	-60°C	-60°C
Max. exposure temperature	180°C	180°C

ORDERING DETAILS

Part description	C25-100-METAL	C3/4-100-METAL
PN (Weight)	875016-000 (0.31 kg)	440588-000 (0.3 kg)

ALTERNATIVE MATERIALS

NICKEL PLATED		
Part description	C25-100-METAL-NP	C3/4-100-METAL-NP
PN (Weight)	1244-002296 (0.31 kg)	1244-001350 (0.3 kg)
STAINLESS STEEL		
Part description	C25-100-METAL-SS	-
PN (Weight)	1244-017869 (0.3kg)	

North America

Tel +1.800.545.6258
Fax +1.800.527.5703
thermal.info@nVent.com

Europe, Middle East, Africa

Tel +32.16.213.502
Fax +32.16.213.604
thermal.info@nVent.com

Asia Pacific

Tel +86.21.2412.1688
Fax +86.21.5426.3167
cn.thermal.info@nVent.com

Latin America

Tel +1.713.868.4800
Fax +1.713.868.2333
thermal.info@nVent.com



nVent.com

Our powerful portfolio of brands:

CADDY ERICO HOFFMAN RAYCHEM SCHROFF TRACER